

FORM NO 1.

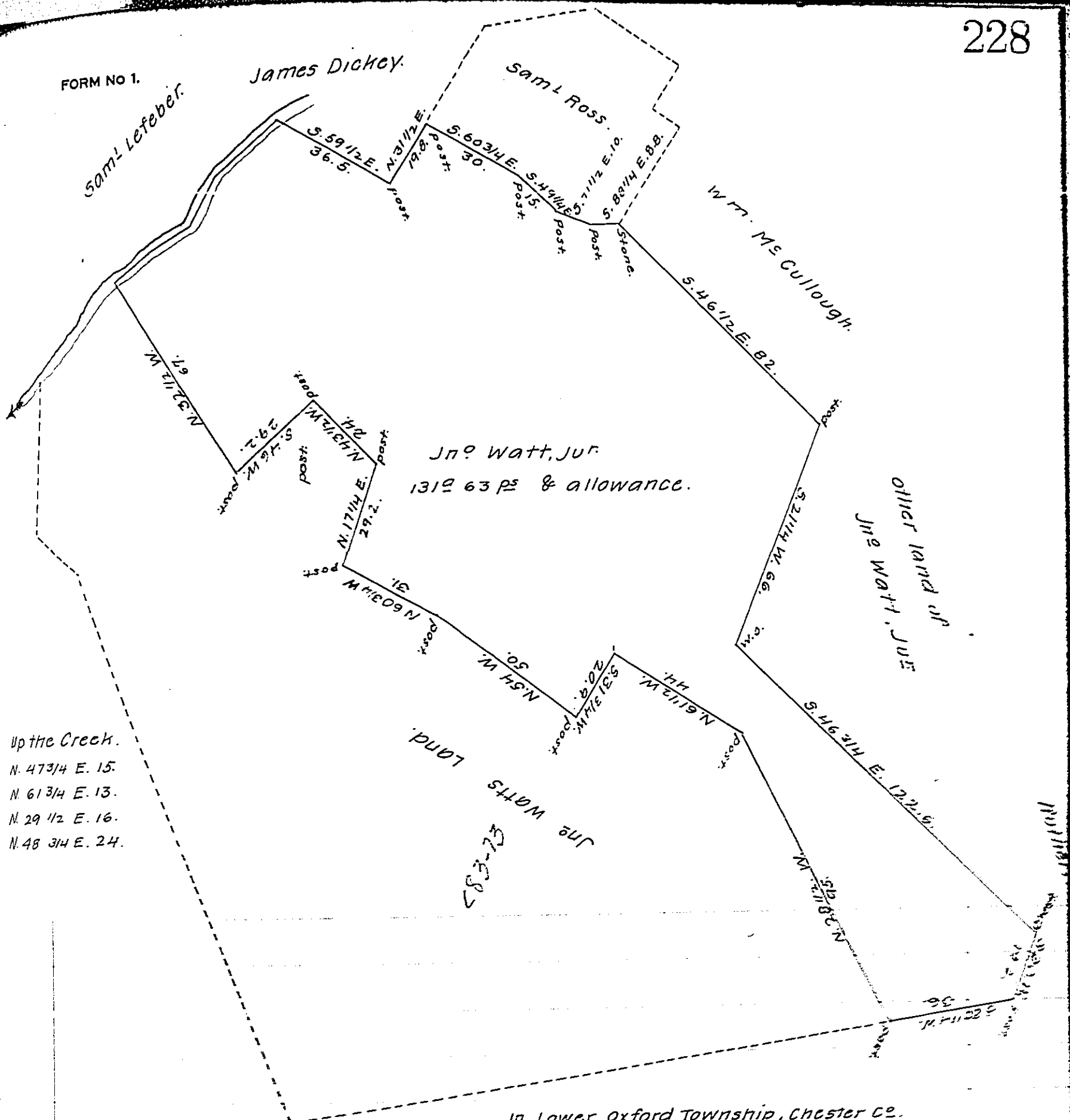

In Lower Oxford Township, Chester Co.  
 The above Draught describes a tract of land, containing 1312 & 63 p and allowance being a part of a large tract containing 2802 and allowance, 1522 thereof surveyed 9th month 1738 by warrant to Jno Galbraith date 25th August 1738 - 72 acres thereof surveyed 7 of March 1747/8 By order to Jno Galbraith 19th March 1746. The remainder to Wm Calbraith by warrant Dated Sep<sup>r</sup> - 4<sup>th</sup> 1754. Surveyed May 1837 By Jesse Evans, D.S.

To \_\_\_\_\_ Esqr. I do certify that the above survey was made by my predecessor  
 Surveyor General and I believe it to be correct.  
 East Nottingham }  
 April 1<sup>st</sup> 1840 }

John Gibson, D.S.

IN TESTIMONY that the above is a copy of the original remaining on file in the Department of Internal Affairs of Pennsylvania, made conformably to an Act of Assembly approved the 16th day of February, 1833, I have hereunto set my Hand and caused the Seal of said Department to be affixed at Harrisburg, this eighth day of November, 1907.

Henry Huck  
 Secretary of Internal Affairs.